

MONTAGEANLEITUNG INSTRUKCJA MONTAŻOWA

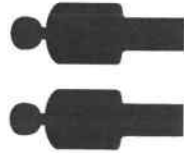

2 Personen
2 Osoby

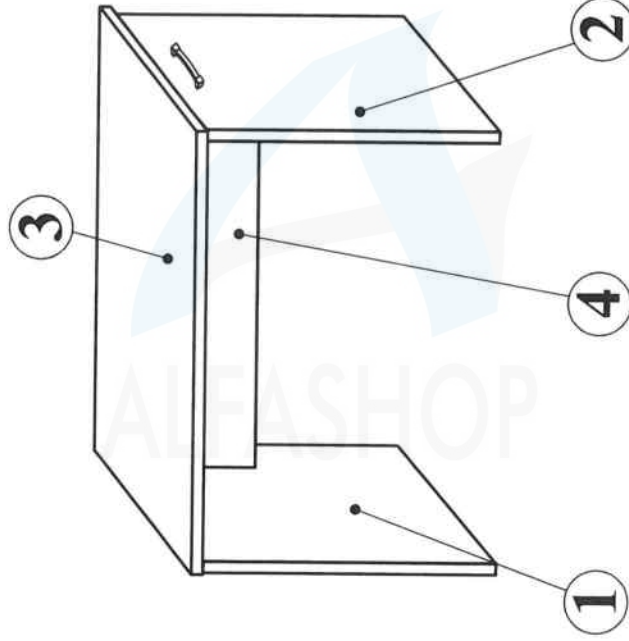
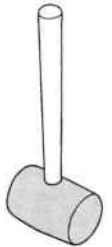

Pflegehinweis!
Bitte nur mit einem Staubtuch oder einem feuchten Lappen reinigen.
KEINE scheuernde Putzmittel verwenden!

Wskazówka dotycząca pielęgnacji!
Proszę czyścić tylko suchą lub lekko wilgotną szmatką do kurzu. Nie używać żadnych środków szorstkich!

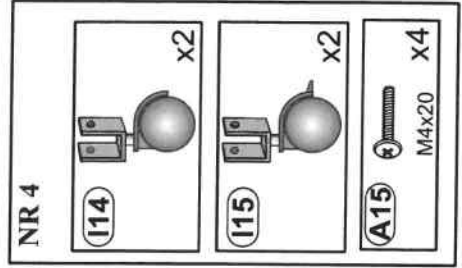
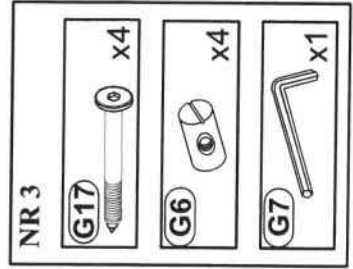
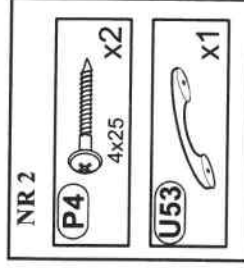
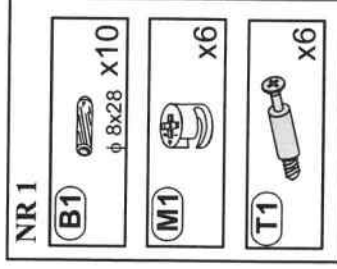

Max. zulässige Belastungen
von Einlegeböden in kg:

Maksymalne obciążenie półek w kg:

Stärke/Di. mm	Spanplatte/Plyta
0<400	15 18 22
401<600	40 40 40
601<800	24
801<1000	15 30

1

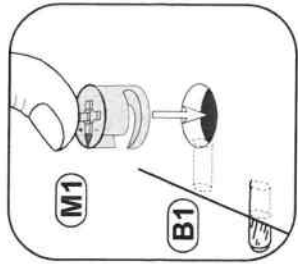

- (M1)** x6
- (B1)** φ 8x28 x10
- (T1)** x6
- (G6)** x4

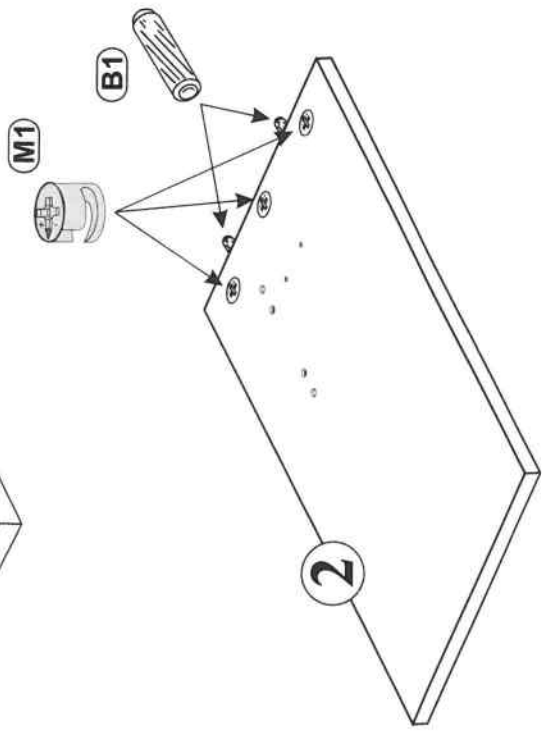
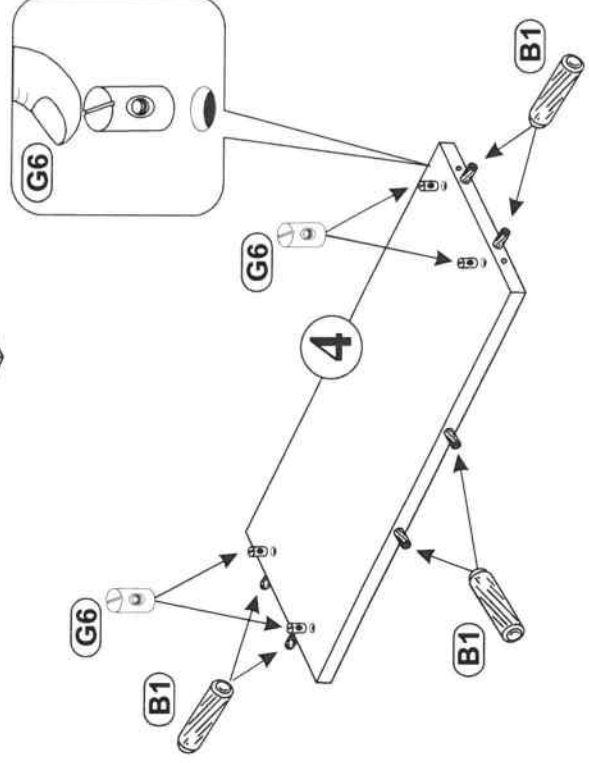
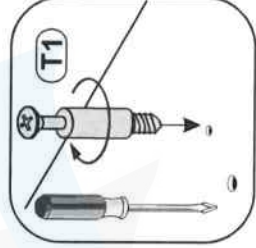
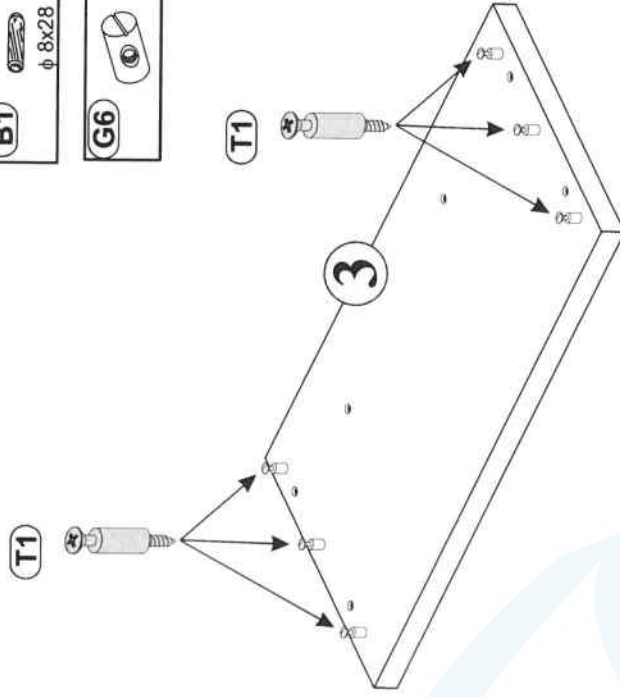
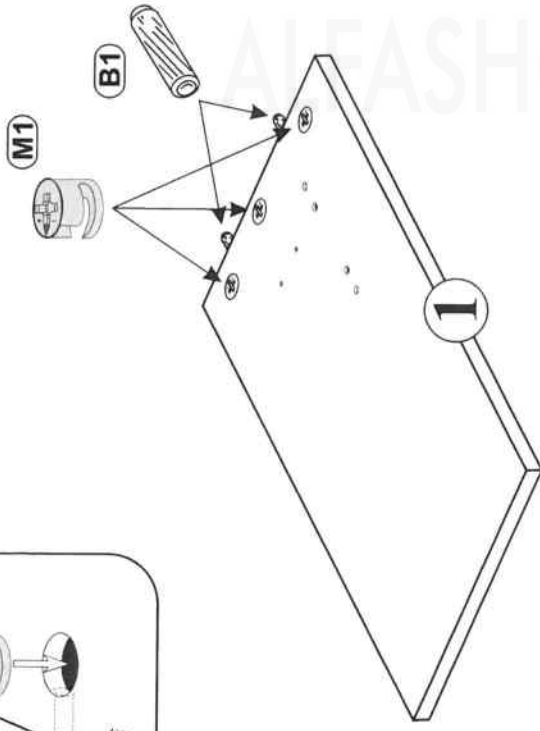

2

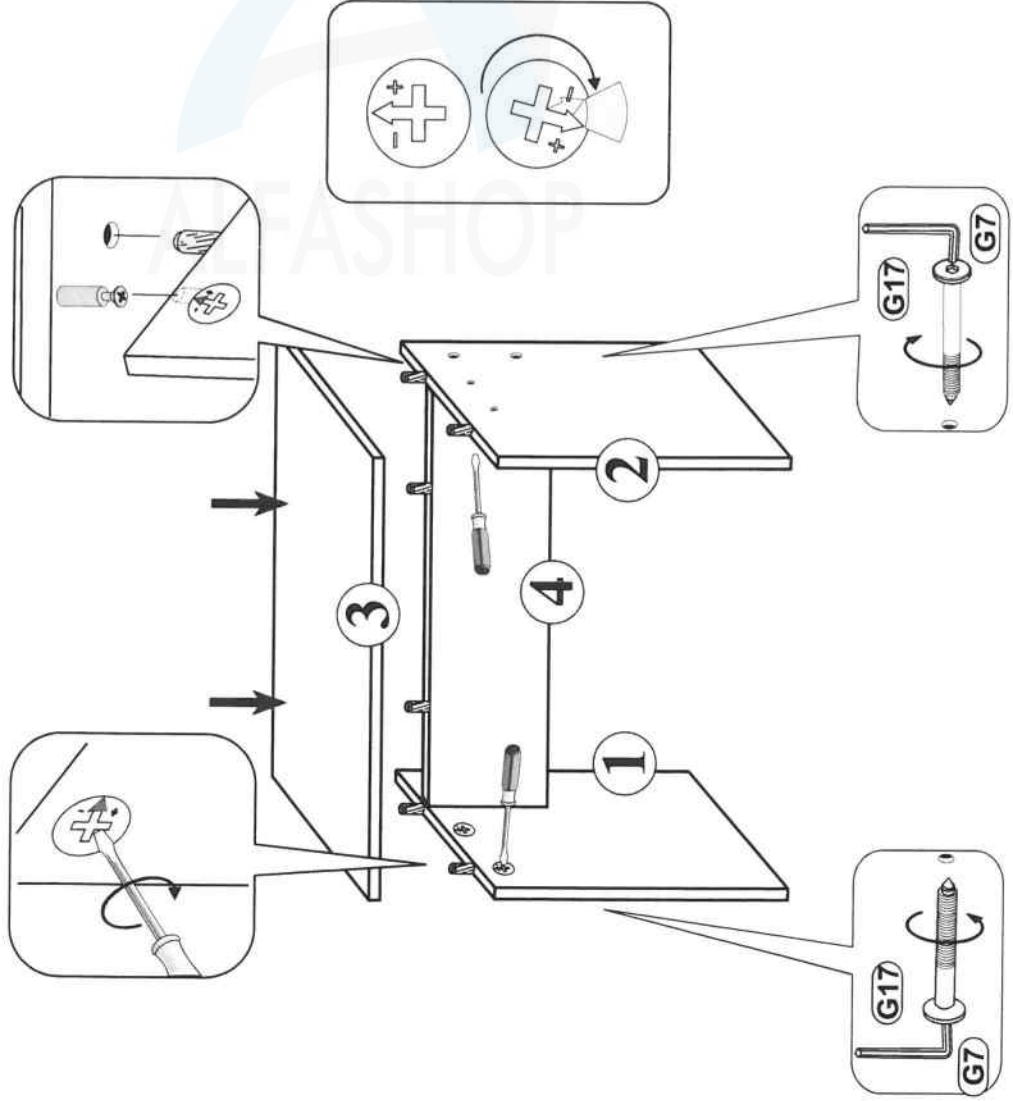
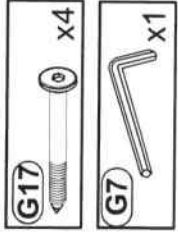

3

